

R120-P30 Quick Reference Guide

P/N:25ME0-R12000-Q0R

Removing System Cover

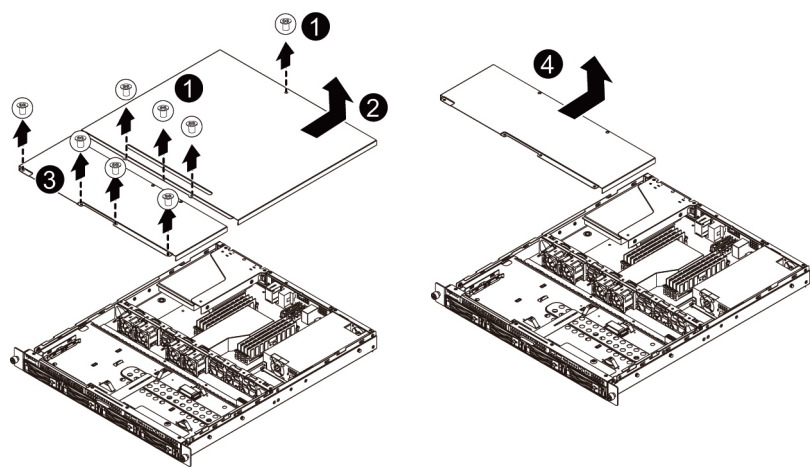

Removing Fan Duct

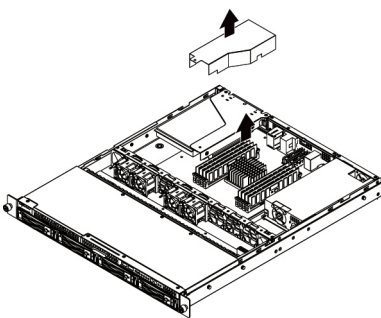

Installing Memory

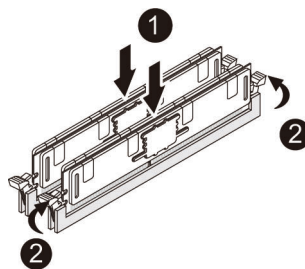

Slot Per Channel (SPC) and DIMM Per Channel (DPC)					
1 Slot	2 Slot		4 Slot		8 Slot
1DPC	1DPC	2DPC	1DPC	2DPC	2DPC
A0 or C0	A0 + B0 or A0 + C0	A0 + A1 or C0 + C1	A0 + B0 + C0 + D0	A0 + A1 + B0 + B1 or A0 + A1 + C0 + C1	Insert Full

Installing Hard Disk Drive

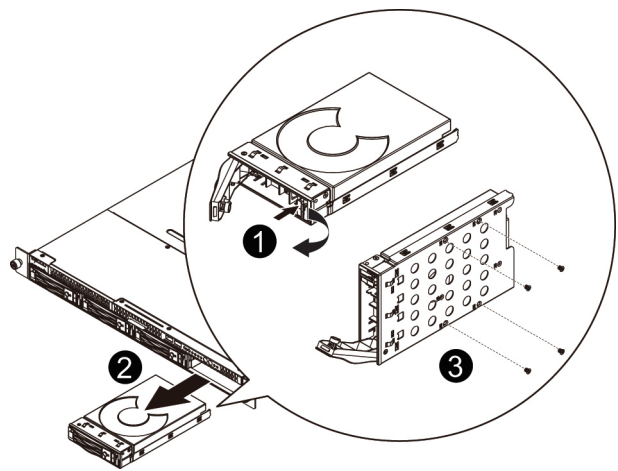

Installing PCI Expansion Card

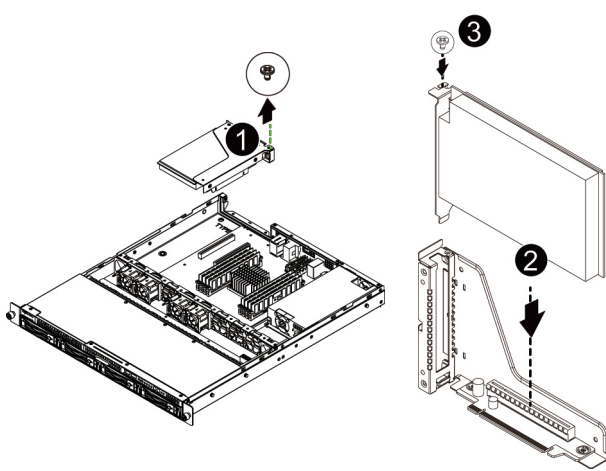

Front Panel LED and Buttons

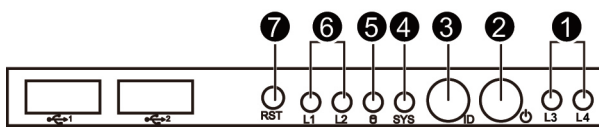

No.	Name	Color	Status	Critical Event	Description
1.	LAN3/4 Active/Link LED	Green	Solid On	N/A	Link between system and network or no access
		Green	Blink	N/A	Data transmission or receiving is occurring
		N/A	Off	N/A	No data transmission or receiving is occurring
2.	Power button and LED	Green	Solid On	N/A	System is powered on
		N/A	Off	N/A	Power off
3.	ID Button and LED	Blue	Solid On	N/A	System identification is active.
		N/A	Off	N/A	System identification is disabled.
4.	System Status LED	Green	Solid On	N/A	System is operating normally.
		Amber	Solid On	Yes	Critical condition, may indicate the following: <ul style="list-style-type: none"><li>Power module failure</li><li>System fan failure</li><li>Power supply voltage issue</li><li>System temperature/voltage issue</li><li>Current error/Processor error</li><li>Critical memory error</li></ul>
					Non-critical condition, may indicate the following: <ul style="list-style-type: none"><li>Temperature and voltage issue</li><li>Current error</li><li>Event Logs almost full</li></ul>
		Blink	N/A	N/A	System is not ready. May indicate the following: <ul style="list-style-type: none"><li>POST error</li><li>Processor or terminator missing</li></ul>
5.	HDD Status LED	Green	Blink	N/A	HDD access
		N/A	Off	N/A	No HDD access No HDD fault
6.	LAN1/2 Active/Link LED	Green	Solid On	N/A	Link between system and network or no access
		Green	Blink	N/A	Data transmission or receiving is occurring
		N/A	Off	N/A	No data transmission or receiving is occurring
7.	Reset Button				Press the button to reset the system.

System Front and Rear View

System Front View

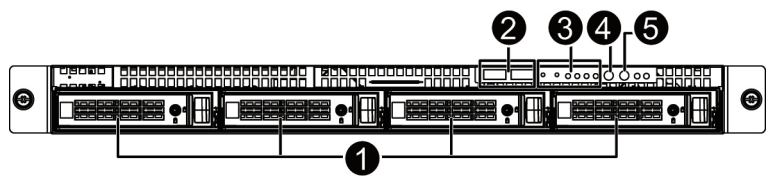

- 1 HDD bays
- 2 Front USB 2.0 ports
- 3 Front panel LED and buttons
- 4 ID switch button
- 5 Power switch button

System Rear View

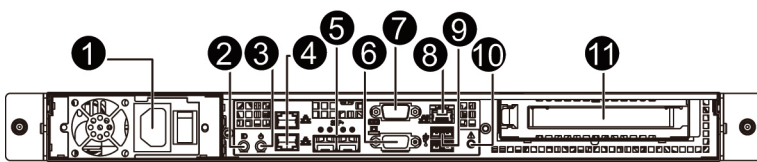

- 1 Power supply module cord socket
- 2 ID switch button
- 3 Power switch button
- 4 LAN ports
- 5 10G LAN ports
- 6 VGA port
- 7 Serial port
- 8 10/100 Server management LAN port
- 9 USB 2.0 ports
- 10 System status LED
- 11 Low-profile riser card bay