

P15 Caddy bay instruction / P15 抽換式光碟機/硬碟操作說明 / P15 캐디 베이 지시서

1

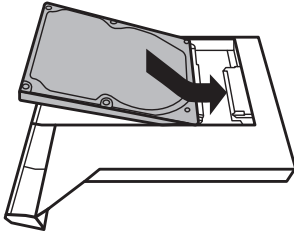

EN

Install the HDD into Caddy bay.

TW

裝上硬碟。

KR

하드디스크를 캐디베이에 설치합니다.

2

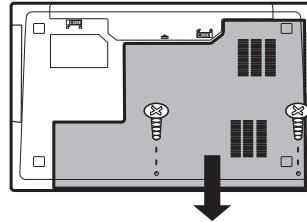

Unplug two screws and open the back cover.

卸除背蓋上 2 顆螺絲，下推打開背蓋。

2개의 볼트를 풀고 뒷 커버를 엽니다.

3

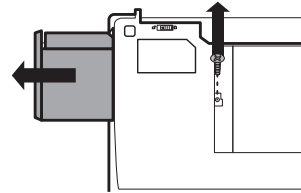

Unplug one screw and take out the ODD bay.

卸下 1 顆螺絲後，取出光碟機。

볼트 하나를 풀고 ODD베이를 빼냅니다.

4

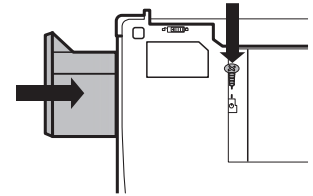

Install the Caddy bay in notebook and lock the screws.

將硬碟裝入筆電，鎖上螺絲，完成。

노트북안에 캐디베이를 설치 후 볼트를 잠금니다.



2Z08-0P151-J90S