

21.5" AIO System Quick Start Guide

Set up the computer

1. Removing PC Cover

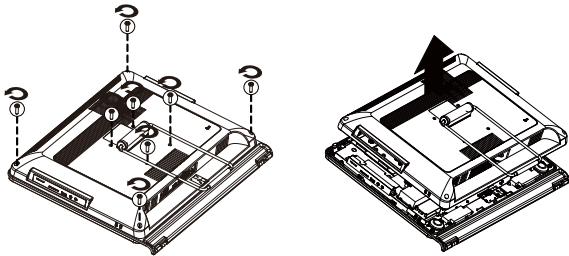

1. Make sure the computer is not turned on or connected to an outlet.
2. Loosen and remove the screws securing the back cover.
3. Remove the back cover from the system.

2. Removing Motherboard Metal Cover

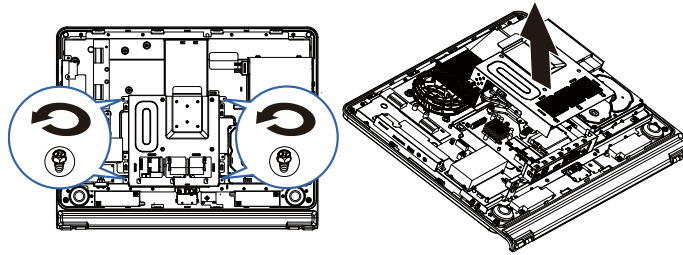

1. Loosen and remove the screws securing the motherboard metal cover.
2. Slide the metal cover away from the I/O ports then lift up.

3. Installing CPU

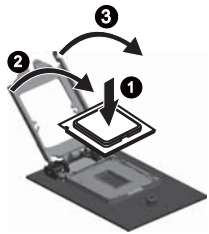

1. Raise the metal locking lever on the socket. Remove the plastic covering on the CPU socket. Then insert the CPU.
2. Replace the metal cover.
3. Push the metal lever back into the locked position.

4. Installing Heat Sink

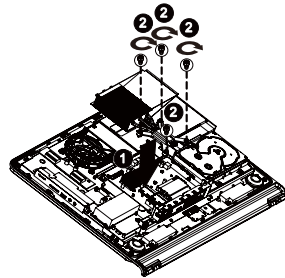

1. Apply an even and thin layer of thermal paste on the surface of the heat sink.
2. Seat the heat sink in the retention modules and secure with the four screws in a diagonal pattern.

5. Installing Memory

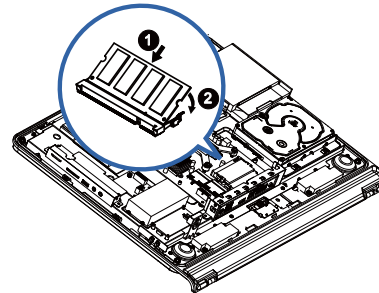

1. Align the memory with the SODIMM and insert the SODIMM memory module into the SODIMM slot.
2. Push down the memory and seat it firmly.

6. Replacing Hard Disk Drive

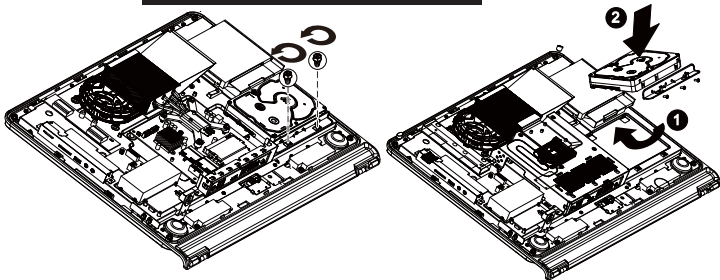

1. Loosen and remove the screws securing the HDD bracket.
2. Insert the HDD into the HDD bay in the direction of the arrow. Loosen the four screws. Push down the memory and secure the screws to the locked place.

7. Installing WiFi Module

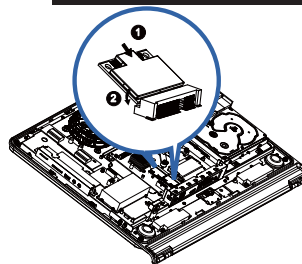

1. Align the WiFi card with the Mini Card Slot and insert the card into the slot.
Please note that the WiFi module has a foolproof insertion design. A WiFi module can be installed in only one direction.
2. Press down the WiFi card and fasten it firmly with a screw.

System I/O Connectors

Left Side

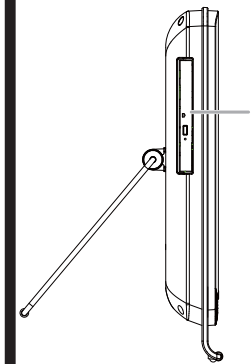

Bottom side

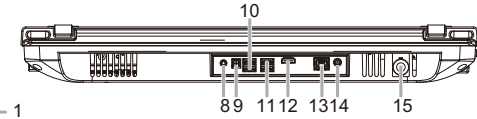

Right Side

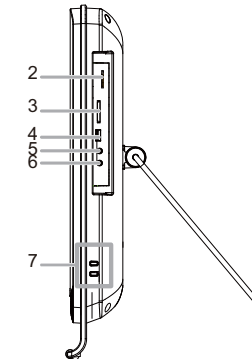

1. Optional DVD Drive
2. B-CAS/SIM
3. Media Card Reader
4. USB Port
5. Microphone Input Jack
6. Audio/Headphone Output Jack
7. Brightness buttons
8. Audio input jack
9. SPDIF OUT
10. USB 3.0 Ports
11. USB Ports
12. HDMI-Out Port
13. LAN Port
14. DC Jack
15. RF Connector

8. Turning On Your PC

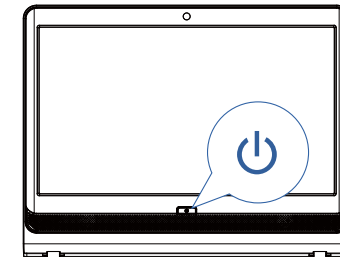

1. Press the PC power button.